

PureFX®



Recessed

6"x4'

1 T8

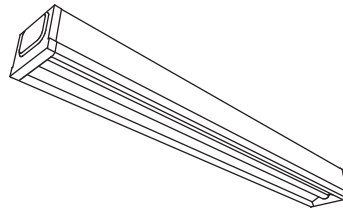

Project Name

Spec Type

Notes

Order Guide

Some combinations of product options may not be available. Consult factory for assistance with your specification.

9464			T132	-		-		-		-	
Product Series & Size	Version	Configuration	Lamping	Housing	Wiring	Voltage	Ballast				
PureFX 6"x4'	D1 Standard T-Grid	ST Standalone CR Continuous Row SMS Standalone Master/Satellite CMS Continuous Row Master/Satellite	1 T8 (32W)	S Standard (22ga.) N New York (20ga.) C Chicago Plenum T Standard w/ Frame Restraint	1 1 cct 5 1 cct w/ Battery Pack 7 1 cct Dimming	1 120V 2 277V 3 347V	E Standard Ballast				
	See details on next page				Consult website for complete list of standard wiring options		Consult website for ballast manufacturer information				

Upgrades & Accessories

Please indicate with check mark.

Lamps Included Lamps Included & Installed

Job Pack

Drywall Kit

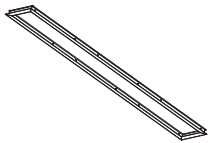

Can be mounted to wood frame or with hanger wire

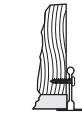

Wood Frame



Hanger Wire

Cross Section

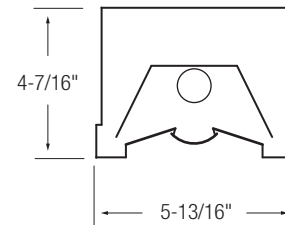

Side View

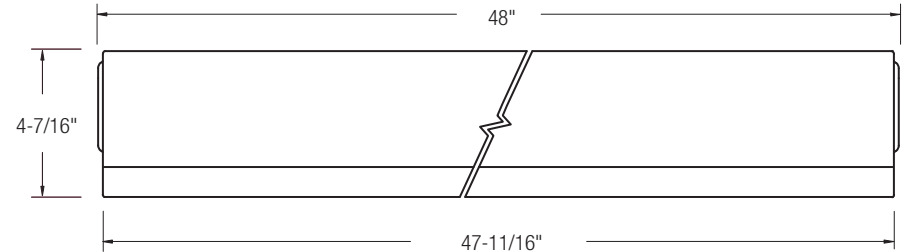

PureFX®

Recessed

6"x4'

1 TB

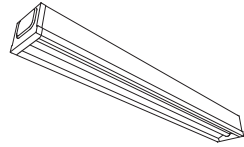

Photometry

Report Summary

Report # 9900024
Filename 9464D1T132.ies
Efficiency 59.4%

Spacing Criteria 1.2 @ 0° along
 0.9 @ 90° across

Meets RP-1-04 recommendations for VDT-Normal spaces

Candela Distribution

Vertical Angle	Horizontal Angle					Zonal Lumens
	0	22.5	45	67.5	90	
0	915	915	915	915	915	
5	909	907	902	897	898	87
15	869	852	821	791	789	230
25	788	739	675	633	628	317
35	656	585	521	488	485	338
45	480	428	386	361	360	308
55	302	285	261	251	250	240
65	156	162	158	140	141	151
75	56	71	66	63	65	70
85	6	13	14	13	15	15
90	0	0	0	0	0	

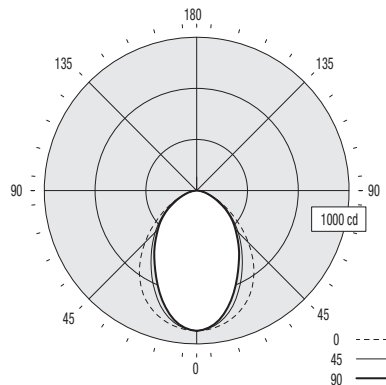

Coefficients of Utilization (%)

Ceiling: Wall:	80				70				50				0				
	70	50	30	10	70	50	30	10	50	30	10	0	70	50	30	10	0
0 RCR	71	71	71	71	69	69	69	66	66	66	66	59					
1	65	63	61	59	64	62	60	59	57	57	56	51					
2	60	56	52	49	59	55	51	53	50	47	44						
3	55	50	45	42	54	49	45	47	44	41	38						
4	51	45	40	36	50	44	39	42	39	35	33						
5	47	40	35	32	46	40	35	38	34	31	29						
6	44	37	32	28	43	36	31	35	31	28	26						
7	41	33	29	25	40	33	28	32	28	25	23						
8	38	31	26	23	37	30	26	29	25	22	21						
9	36	28	24	21	35	28	24	27	23	20	19						
10	34	26	22	19	33	26	22	25	21	19	18						

Based on a floor reflectance of 0.2

Avg. Luminance (cd/m²)

Vertical Angle	Horizontal Angle		
	0	45	90
55	4482	3874	3711
65	3143	3183	2840
75	1842	2171	2138
85	586	1368	1465

IES files for this and other photometric options can be downloaded online at www.ledalite.com

Additional Information

Mounting

Integrates with most common T-bar ceiling types.

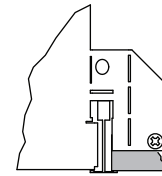

D1 Standard T-Grid

Option D1 works with 9/16" and 15/16" flat T-grid ceilings. It can also be used with slot T-grid ceilings, but it will not sit flush with the bottom of the T-bar.

Ceiling Types

Integrated mounting tabs can be field-adjusted to various T-bar ceiling heights for fastening directly to the T-bar grid and/or tied-off to the building structure.

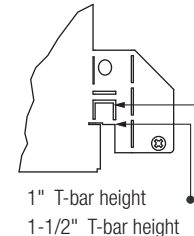

1" T-bar height

1-1/2" T-bar height

Specifications

Due to continuing product improvements, Ledalite reserves the right to change specifications without notice.

Housing

Die-formed, post-painted, 22 gauge cold-rolled steel (New York City version is 20 gauge). Wire entrances are positioned on the side of the housing to allow easy wiring access for the installer. Multiple wire entrances are available on top or side to allow continuous row mounting of fixtures. Optional frame restraint is available to provide additional support to the optical frame.

Weight

Maximum 18 lbs.

Optical System

Optical assembly consists of flat acrylic panels and extruded curved acrylic lens. A protected MesoOptics® film layer creates optimal light distribution and high efficiency. The optical frame ends are constructed from die-formed cold-rolled steel assembled together with extruded aluminum profiles in a sturdy frame. The frame is hinged to allow easy access to the inside of the fixture. Maintenance can be performed from below the ceiling without tools. No hardware is visible.

Mounting

Fixture is compatible with most ceiling types. Integrated bend-out tabs are provided for different T-grid heights. Optional drywall kit is available for non-accessible ceilings. Use screws or hanger wire (supplied by others) to secure fixture.

Ballast

Electronic. Supplied with pre-installed ballast disconnects as per national electric codes.

Wiring

Optional flex whips are supplied in 6' lengths for 1x4, 2x2 and 2x4 fixtures. Flex connectors are supplied in 9' lengths for standard master/satellite configurations.

Air Return

Air return option available in 2'x2' and 2'x4' sizes only. Side rails are finished in black.

Approvals

Certified to UL & CSA Standards.
 City of Chicago Approved CCEA (housing option C).
 Designed to comply with NYC code requirements (Housing Option N).

Finish

Housing and Frame: Post-painted, high quality powder coat. Available in white only.